

2012 Kentucky Fruit and Vegetable Conference and Trade Show

JANUARY 5-6, 2012

Thursday and Friday

Kentucky State Horticulture Society
156th Annual Meeting

Kentucky Vegetable Growers Association
41th Annual Meeting

Kentucky Farmers' Market Association
6th Annual Meeting

Organic Association of Kentucky
3rd Annual Meeting

Kentucky Vineyard Society
Annual Meeting

Kentucky Wine Association

*In cooperation with:
University of Kentucky
College of Agriculture
Kentucky State University
and
Kentucky Department of Agriculture*

Meeting Place:
Embassy Suites Hotel
1801 Newtown Pike
Lexington, Kentucky 40511
(859) 455-5000
FAX (859) 455-5122
Reservations: 800-EMBASSY

Meeting Outline

Wednesday, January 4 Pre-conference Sessions

Room

3:00-5:30 p.m.	Winemaking Techniques Workshop	Coldstream 1 & 2
7:30-9:30 p.m.	Fruit Round Table Discussion	Coldstream 4
5:00-9:00 p.m.	Exhibitor Set-up	

Thursday, January 5

8:00 a.m.	Exhibits Open	
8:50 a.m.	Concurrent Sessions	
	KSHS-KVGA Joint Session	Coldstream 3
	Winemaking	Coldstream 1 & 2
10:30 a.m.	Break	
Noon	Exhibitors & Growers Luncheon	Coldstream 1 & 2
1:30 p.m.	Concurrent Sessions	
	Farmers' Markets	Coldstream 1 & 2
	Agritourism and Social Media	Coldstream 3
	Vegetable Production	Coldstream 4
	Tree Fruit And Blueberry Production	Coldstream 5
2:30 p.m.	Break	
5:15 p.m.	Exhibits Close	
5:00-6:00 p.m.	Celebration of Kentucky Wines	Coldstream 1 & 2
6:30-9:00 p.m.	Reception and Kentucky Farmers' Market	
	Association Annual Meeting	Coldstream 3

Friday, January 6

8:00 a.m.	Exhibits Open	
8:30 a.m.	Concurrent Sessions	
	Organic Farming and Gardening	Coldstream 1 & 2
	Vegetable Production	Coldstream 3
	Grape & Wine Short Course	Coldstream 4
	Tree Fruit	Coldstream 5
	Blueberry Production	Fayette
10:00 a.m.	Break	
11:45 a.m.	Grower Awards Luncheon	Coldstream 1 & 2
1:30 p.m.	Concurrent Sessions	
	Small Fruit Production	Coldstream 1 & 2
	Marketing	Coldstream 3
	Grape & Wine Short Course	Coldstream 4
	Hydroponic Tomato Production	Coldstream 5
	Wholesale Marketing	Fayette
2:30 p.m.	Break	
3:00 p.m.	Exhibit Hall Closes	

Dear Fruit and Vegetable Growers:

The 2012 Kentucky Fruit and Vegetable Conference and Trade Show will again be at the Embassy Suites Hotel, Lexington, KY, Thursday and Friday, January 5 and 6, 2012. Highlights of this year's meeting will be a pre-conference Winemaking Techniques Workshop and a Fruit Round Table Discussion. During the conference there will be sessions on Farmers' Markets, Commercial Fruit and Vegetable Production, Hydroponic Tomato Production, Small Fruit Production, Organic Farming and Gardening, the Grape and Wine Short Course, Winemaking, Agritourism and Social Media, Marketing, Wholesale Marketing, and Blueberry Production. We have many excellent out-of-state speakers this year including Dr. Mike Ellis, Extension Plant Pathologist; Dr. Diane Miller, Associate Professor, and Kyle Daniel, Ph.D. student from Ohio State University; Jeff Kindhart, Senior Research Specialist, Dixon Springs Agricultural Center, Simpson, IL; Dr. Rick Snyder, Extension Specialist for Greenhouse and Field Vegetable Crops, Mississippi State University, Crystal Springs, MS; Richard Barnes, Trellis Growing Systems, Fort Wayne, IN, and Dr. David Lockwood, and Dr. Annette Wszelaki, Extension Fruit and Vegetable Specialists respectively, from the University of Tennessee, Knoxville, TN.

The KVS will have an optional Celebration of Kentucky Wines featuring Kentucky wines. This year we have decided not to have a banquet and will have a Grower Awards Luncheon instead on January 6th.

We will have a Trading Post bulletin board to sell used equipment. If you are looking for equipment buyers, bring along a description containing your name, phone number and the equipment price.

PLEASE make your room reservations directly with the hotel. **Our block of rooms will be held until Jan. 2, 2012. After this, room prices will be higher.** Be sure to let the hotel know that you will be staying for the Kentucky Fruit and Vegetable Conference to obtain our special suite room rate (they are all suites) of \$115.00. If you are told that the block of rooms at our conference rate is full on or before Jan 2, please call Amy Stamper at Embassy Suites (859-455-5109) to increase the number of rooms that we have blocked. The room cost includes an evening managers' reception with drinks and a full cooked-to-order breakfast daily. We encourage growers to stay at Embassy Suites Hotel to help cover meeting overhead expenses. Note: if the hotel parking lot is full, meeting attendees may park along Aristides Street in front of the hotel.

The \$30 meeting registration fee includes a year's membership in the KVGA, KSHS or OAK and entrance into the Grape & Wine Short Course. Please see the registration form to become a member of the Kentucky Vineyard Society and to sign up for the meal functions and the Celebration of Kentucky Wines.

The enclosed pre-registration form enables you to preregister so your tickets and name tag will be ready for you when you arrive at the meeting. NOTE: WE STRONGLY URGE YOU TO PRE-REGISTER. LUNCHEON TICKETS MAY NOT BE AVAILABLE AT THE REGISTRATION DESK. NAME BADGES WILL BE REQUIRED TO ENTER MEETING ROOMS. PRE-REGISTRATION FORMS NEED TO BE IN OUR HANDS BY TUESDAY DECEMBER 20, 2011. Phone registrations will not be accepted. Participants that do not pre-register may register at the door. If you would like to serve on the KVGA or KSHS boards of directors or would like to nominate another member, please designate this on your registration sheet.

If circumstances are such that you cannot attend the meeting and would like to remain a member of the KVGA, KSHS, KVS, or OAK, please complete and return the form to Ms. Mary Ann Kelley, Research & Education Center, P.O. Box 469, Princeton, KY 42445 to continue your association membership.

Sincerely,

Robert Stone, President
KY Vegetable Growers Association

Larry Ayres, President
KY State Horticultural Society

**KENTUCKY STATE HORTICULTURAL
SOCIETY OFFICERS**

President: Larry Ayres, Owenton
Vice-President: Jeremy Hinton, Hodgenville
Secretary: Doug Archbold, Lexington
Treasurer: Cindy Peake, Mt. Sterling
Directors: Donald Davis, South Shore
Joanna Hinton, Hodgenville
Terry Peake, Mt. Sterling
Ray Armstrong, Shepherdsville
Cal Blake, Lexington
Maurice Fegenbush, Bloomfield
Mat Gajdzik, Shelbyville
Jonathan Price, Bowling Green
Katie Reid, Owensboro

Advisors: Ed Fackler, New Salisbury, IN
Kirk Pomper, Frankfort
John Strang, Lexington
Shawn Wright, Jackson

**KENTUCKY VEGETABLE GROWERS
ASSOCIATION OFFICERS**

President: Robert Stone, Paris
Vice-President: Butch Case, Cynthiana
Secretary: Beth Wilson, Somerset
Treasurer: Kevin Trunnell, Utica
Directors: John Bell, Georgetown
Brent Lackey, Somerset
Zeldon Angel, Winchester
Sandi Deutsch, Taylorsville
Annette Meyer-Heisdorffer,
Owensboro
C.A. Pantle, Jr., Owensboro
Linda McMaine, Salvisa
Sarah Fannin, West Liberty
Larry Snell, Elizabethtown
Adam Watson, Frankfort
Joel Wilson, Nancy

Advisors: Tim Coolong, Lexington
Mac Stone, Frankfort
John Strang, Lexington
Shawn Wright, Jackson

**KENTUCKY FARMERS' MARKET
ASSOCIATION OFFICERS**

President: Janet Eaton, Wilmore
Vice-President: Larry Ayres, Owenton
Secretary: Stephanie Wetzel, Richmond
Treasurer: Janet Eaton, Wilmore
Directors: Linda McMaine, Salvisa
Ron Gurelle, Walton
Sandy Corlett, Shelbyville
Jane O'Tiernan, Richmond

**ORGANIC ASSOCIATION OF
KENTUCKY OFFICERS**

President: Larry Brandenburg, Shelbyville
Vice-President: Kim Jordon, Frankfort
Secretary: Brian Geier, Frankfort
Treasurer: Molly Stotts, Winchester
Directors: Ben Abell, Lexington
John Bell, Georgetown
Cheryll Frank, Georgetown
Sarah Fritchner, Louisville
Deborah Hill, Frankfort

Advisors: Michael Bomford, Frankfort
Sean Clark, Berea
Tim Coolong, Lexington
Michael Fitzgerald, Frankfort
Mark Williams, Lexington

**KENTUCKY VINEYARD
SOCIETY OFFICERS**

President: Lowell Land, Richmond
Vice-President: Bruce Kunze, Utica
Secretary: Chad Peach, Frankfort
Treasurer: Alex Ackerman, Lebanon
Executive Dir: Alicia McGuire, Lexington
Directors: Tom Beal, Nicholasville
Jim Hatchett, Springfield
Bob Karsner, Willisburg
Roger Leasor, Lexington
Joey Sloan, Lawrenceburg
Zane Burton, Somerset

KENTUCKY WINE ASSOCIATION

President: Eddie O'Daniel, Bloomfield

All Times Are Eastern Standard Time

**WEDNESDAY, JANUARY 4
PRE-CONFERENCE SESSIONS**

- 3:00-5:30 p.m. **WINEMAKING TECHNIQUES WORKSHOP**
Coldstream 1 & 2 Rooms
Patsy Wilson and Jeff Wheeler, Presiding
- 7:30-9:00 p.m. **FRUIT ROUND TABLE DISCUSSION**
Coldstream 4 Room
John Strang, Presiding
- 5:00-9:00 p.m. **Exhibitor Set-up**
Pre-Function Area & Lower Atrium

Literature Table

Central Kentucky Ag Credit
640 South Broadway
P.O. Box 1290
Lexington, KY 40588
PH: 859-253-3249
randerson@AgCreditOnline.com

Nourse Farms, Inc.
41 River Rd.
South Deerfield, MA 01373
PH: (413) 665-2658
info@noursefarms.com

Stokes Seeds
13265 Howe Rd.
Fishers, IN 46038
PH: 317-409-3445
kwagner@stokeseeds.com

THURSDAY, JANUARY 5

8:00 a.m. Exhibits Open, Pre-Function & Lower Atrium Areas
8:00 a.m. Registration, Pre-Function area outside meeting rooms
Meeting registration is \$30.00. Please see the registration form for association memberships.

(1) KSHS-KVGA JOINT SESSION

*Coldstream 3 Room
Robert Stone Presiding*

(2) WINEMAKING

*Coldstream 1 & 2 Rooms
Jeff Wheeler, Presiding*

(3) ORGANIC ASSOC. OF KENTUCKY WINTER MEETING

*Fayette Room
Larry Brandenburg,
Presiding*

8:45 a.m. Welcome - Larry Ayres

8:55 a.m. Horticulture Department
Update - Bob Houtz

9:00 a.m. Horticulture Council Update
- Jeff Hall

9:00 a.m. Sheet Filtration
- Conor O'Hara

9:15 a.m. Kentucky Department of
Agriculture Produce
Marketing Update
- James Comer,
Commissioner of Ag.

9:30 a.m. The Kentucky Food Systems
Innovation Center
- Melissa Newman

9:30 a.m. Membrane Filtration
- Ed Marchetti

9:45 a.m. Introduction to Applying for
Grants - Larry Snell

10:00 a.m. The Vegetable Scene in China
- John Snyder

10:00 a.m. Winery Sanitation
- Joe Lutomske

10:30 a.m. Cider/Coffee Break and
Visit Exhibits
- Pre-Function and Lower
Atrium Areas

10:30 a.m. Cider/Coffee Break
and Visit Exhibits
- Pre-Function and
Lower Atrium Areas

11:00 a.m. Kentucky Grown Ag Product
State Resort Park Purchasing
- Gerry Van Der Meer

11:00 a.m. Late Harvest Wine:
Cultivar Selection
& Wine Tasting
- Jeff Wheeler

11:00 a.m. Organic Association
of Kentucky Winter
Meeting

11:15 a.m. Entrepreneurial Training
- Kim Strohmeier

11:30 a.m. Herbicide Residues in Hay,
Mulch and Compost
- J.D. Green

11:45 a.m. Heavy Metal Soil and Water
Contamination
- Edwin Ritchey

All Times Are Eastern Standard Time

THURSDAY AFTERNOON, JANUARY 5

12:00 noon **EXHIBITORS AND GROWERS LUNCHEON** - Coldstream 1 & 2 Rooms

12:00 noon. **KVGA AND KSHS BOARD MEETINGS**

Board members should pick up their lunch at the Coldstream 1 & 2 buffet and then meet in the designated room at the top of the stairs located over the meeting rooms.

Kentucky State Horticultural Society - Paris Room

Kentucky Vegetable Growers Association - Georgetown Room

1:30 p.m. **KVS BOARD MEETING**

Kentucky Vineyard Society Board Meeting - Paris Room

Lowell Land, Presiding

5 CONCURRENT SESSIONS

Concurrent sessions will enable participants to attend topics of interest in different sessions

(4) FARMERS' MARKETS

Coldstream 1 & 2 Rooms

Sharon Spencer, Presiding

(5) AGRITOURISM AND SOCIAL MEDIA

Coldstream 3 Room

Ben Shaffar and

Kristin Goodin, Presiding

(6) VEGETABLE PRODUCTION

Coldstream 4 Room

Glen Roberts, Presiding

1:30 p.m.	Home-based Processor and Micro-processor - Everything You Need to Know - Shadrick Adams and Donna Stucker	1:30 p.m.	Are You Ready for Motor Coach Tours? - Pam Upton	1:30 p.m.	Cover Crops, Crop Rotation, Weed Control, and Nutrient Contributions - Annette Wszelaki
2:00 p.m.	Heirloom Vegetables - Old is New Again - Bill Best	2:00 p.m.	How to Effectively Garner and Conduct School Tours at Your Agritourism Business - Cindy Peake	2:00 p.m.	Continued
2:30 p.m.	Cider/Coffee Break and Visit Exhibits - Pre-Function and Lower Atrium Areas	2:30 p.m.	Cider/Coffee Break and Visit Exhibits - Pre-Function and Lower Atrium Areas	2:30 p.m.	Cider/Coffee Break and Visit Exhibits - Pre-Function and Lower Atrium Areas
3:10 p.m.	Farmers' Market of the Year Competition Summary - Janet Eaton	3:10 p.m.	Marketing your Business through Facebook and Twitter - Anna Lucio	3:10 p.m.	Vegetable Cultivar Trial Results (Peas, Eggplant, Seedless Watermelon, and Heirloom Tomatoes) - Tim Coolong, Chris Smigell, and Crystal Sparks,
3:40 p.m.	Ag Credit Ag Genius Awards - Farmers' Market and Mechanization Innovations - John Wilhoit	3:40 p.m.	2012 USDA Grant and Loan Programs - Jeff Jones	3:40 p.m.	Vegetable Crop Evapotranspiration and Irrigation in Tomatoes - Nathan Howell
		4:10 p.m.	What You Need to Know Before You Start Adding Value to Products - Angela Anandappa	4:10 p.m.	Vegetable Crop Irrigation and Mulches - Tim Coolong
				4:40 p.m.	Continued

**(7) TREE FRUIT AND BLUEBERRY
PRODUCTION**

*Coldstream 5 Room
Ray Tackett, Presiding*

(8) ASSOCIATION MEETINGS

Fayette Room

- 1:30 p.m. Peach Irrigation and Fertigation
- Dave Lockwood
- 2:00 p.m. Sensor Equipped Smart Sprayers - Joe Luck
- 2:30 p.m. Cider/Coffee Break and Visit Exhibits
- Pre-Function and Lower Atrium Areas
- 3:10 p.m. Fungicide Resistance and Fungicide Rates
- Mike Ellis
- 3:40 p.m. Acid Injection to Adjust Soil pH in Blueberries
- Dave Lockwood
- 4:10 p.m. Apple Rootstocks - John Strang
- 4:40 p.m. MAIA Progress and New Apple Cultivar Tasting
- Diane Miller, Ed Fackler and Jozsef Racsko

- 1:30 p.m. Kentucky Wine Association Meeting,
- Eddie O'Daniel, Presiding
- 2:30 p.m. Cider/Coffee Break and Visit Exhibits
- Pre-Function and Lower Atrium Areas
- 3:10 p.m. Kentucky Grape and Wine Council
Meeting
- Dennis Walter, Presiding

THURSDAY EVENING, JANUARY 5

5:00 p.m. **Exhibits Close**

5:00-6:00 p.m. **CELEBRATION OF KENTUCKY WINES**

Featuring Commercial Kentucky Wines - Coldstream 1 & 2 Rooms

Sponsored by the KVS. The cost is \$15.00 for the tasting. (Baker-Bird Winery, Crocker Farm Winery, Generation Hill Winery, Glisson Vineyards & Winery, Grimes Mill Winery, McIntyre's Winery & Berries, MillaNova Winery, Misty Meadow Winery, Rock Springs Vineyard & Winery, The Little Kentucky River Winery, Verona Vineyards)

6:30-9:00 p.m. **RECEPTION AND KY FARMERS' MARKET ASSOCIATION ANNUAL MEETING**

*Coldstream 3 Room
Janet Eaton, Presiding*

FRIDAY MORNING, JANUARY 6

- 8:00 a.m. Exhibits Open, Pre-Function and Lower Atrium Areas
8:00 a.m. Registration, Pre-Function Area outside meeting rooms

5 CONCURRENT SESSIONS

Concurrent sessions will enable participants to attend topics of interest in different sessions.

(9) ORGANIC FARMING AND GARDENING

Coldstream 1 & 2 Rooms
Michael Fitzgerald, Presiding

(10) VEGETABLE PRODUCTION

Coldstream 3 Room
Jay Hettmansperger, Presiding

- | | | | |
|------------|--|------------|--|
| 8:30 a.m. | Fall Cole Crop Production
- Ben Abell | 8:30 a.m. | Plant Disease Resistance and Induced Resistance - Kenny Seebold |
| 9:00 a.m. | The Search for Organic Alternatives to Copper Fungicides - Paul Vincelli | 9:00 a.m. | Bacterial Fruit Blotch, Vegetable Fungicide, Insecticide, and Herbicide Changes
- Kenny Seebold, Ric Bessin, and Shawn Wright |
| 9:30 a.m. | The NRCS EQUIP Program
- Kate Little | 9:30 a.m. | KVGA Annual Business Meeting |
| 10:00 a.m. | Cider/Coffee Break and Visit Exhibits
- Pre-Function and Lower Atrium Areas | 10:00 a.m. | Cider/Coffee Break and Visit Exhibits
- Pre-Function and Lower Atrium Areas |
| 10:40 a.m. | Organic Pawpaw, Sweet Sorghum, and Primocane Blackberry Production
- Kirk Pomper | 10:40 a.m. | Grower Vegetable Demonstration Plot Results
- Ty Cato, Vaden Fenton, and Dave Spalding |
| 11:45 a.m. | GROWER AWARDS LUNCHEON
- Coldstream 1 & 2 Rooms
Robert Slone, Presiding | 11:10 a.m. | Asparagus Production - Shawn Wright |

FRIDAY AFTERNOON, JANUARY 6

Concurrent sessions will enable participants to attend topics of interest in different sessions.

(14) SMALL FRUIT PRODUCTION

Coldstream 1 & 2 Rooms
Andrea Dee, Presiding

(15) MARKETING

Coldstream 3 Room
Brett Reese, Presiding

- | | | | |
|-----------|--|-----------|--|
| 1:30 p.m. | The Rotatable Cross Arm Trellis for Blackberries - Richard Barnes | 1:30 p.m. | Economic Impacts of Sampling at Farmers' Markets - TBA |
| 2:00 p.m. | Continued | 2:00 p.m. | Market Maker Training
- Tim Woods |
| 2:30 p.m. | Cider/Coffee Break
- Pre-Function and Lower Atrium Areas | 2:30 p.m. | Cider/Coffee Break - Pre-Function and Lower Atrium Areas |
| 3:10 p.m. | Taking on The Most Prominent Strawberry and Bramble Diseases
- Mike Ellis | 3:10 p.m. | Restaurant Rewards and Point of Purchase Merchandising
- Angela Caporelli |
| 3:40 p.m. | Growing Black Raspberries
- Shawn Wright | 3:40 p.m. | Farm-to-School Program
- Sarah Fritschner |
| 4:10 p.m. | Table Grapes Can Be Very Profitable
- Sean Lynch | 4:10 p.m. | An Introduction to The H2A Program
- Rick Alexander |

FRIDAY MORNING, JANUARY 6

- 8:00 a.m. Exhibits Open, Pre-Function and Lower Atrium Areas
8:00 a.m. Registration, Pre-Function Area outside meeting rooms

5 CONCURRENT SESSIONS

Concurrent sessions will enable participants to attend topics of interest in different sessions.

(11) GRAPE & WINE

SHORT COURSE

Coldstream 4 Room
Lowell Land, Presiding

- 8:55 a.m. Welcome Address
- Lowell Land
9:00 a.m. Effective Vineyard Spraying
- Understanding Your Sprayer
- Andrew Landers
9:30 a.m. Continued
10:00 a.m. Cider/Coffee Break and Visit
Exhibits - Pre-Function and
Lower Atrium Areas
10:40 a.m. Waste Not - Want Not!
- Methods of Improving Spray
Deposition and Reducing Drift
- Andrew Landers
11:10 a.m. Continued
11:45 a.m. GROWER AWARDS LUNCHEON

(12) TREE FRUIT

Coldstream 5 Room
Lowell Hamilton, Presiding

- 8:30 a.m. Tree Fruit Spray Guide
Update and Pest
Management Changes
- Ric Bessin, Nicole Ward,
and John Strang
9:00 a.m. Brown Rot Control in
Stone Fruit - Nicole Ward
9:30 a.m. Glyphosate and Winter
Hardiness - Kyle Daniel
10:00 a.m. Cider/Coffee Break and
Visit Exhibits - Pre-
Function and Lower Atrium
10:40 a.m. Reducing Organophosphate
Use in Apples, Grower
Discussion - Ric Bessin
11:10 a.m. KSHS Annual Business
Meeting

(13) BLUEBERRY

PRODUCTION

Fayette Room
Dennis Morgeson, Presiding

- 8:30 a.m. Basic Blueberry
Production - Jeff Kindhart
9:00 a.m. Netting for Bird Control
in Blueberries
- Nancy McCormick,
Dana Reed, Kevan Evans
9:30 a.m. Common Reasons for
Failure - Jeff Kindhart
10:00 a.m. Cider/Coffee Break and
Visit Exhibits - Pre-Function
and Lower Atrium Areas
10:40 a.m. Blueberry Automated
Simulated Pulsed Irrigation
- John Strang
11:10 a.m. Blueberry Disease Control
- Mike Ellis

FRIDAY AFTERNOON, JANUARY 6

Concurrent sessions will enable participants to attend topics of interest in different sessions.

(16) GRAPE AND WINE SHORT COURSE

Coldstream 4 Room
Alicia McGuire, Presiding

- 1:30 p.m. Grape Disease Identification
and Timing of Control
- Mike Ellis
2:30 p.m. Cider/Coffee Break - Pre-
Function and Lower Atrium Areas
3:10 p.m. Alternative Control Methods for
Japanese Beetles - Ric Bessin
3:40 p.m. Wine Marketing and Economic
Outlook - Tim Woods
4:10 p.m. State of the Industry
- Dennis Walter and KDA
4:45 p.m. Ag Credit Ag Genius
Awards Ceremony
5:15-6:45 p.m. KVS Closing Reception and
Ag Credit Ag Genius Wine Tasting
(*Bourbon Room*) - Lowell Land
& Alicia McGuire

(17) Hydroponic Tomato Production

Coldstream 5 Room
Kelly Jackson, Presiding

- 1:30 p.m. Water Quality
- Steve Berberich
2:00 p.m. Hydroponic Tomato
Production
- Rick Snyder
2:30 p.m. Cider/Coffee Break
- Pre-Function and Lower
Atrium Areas
3:10 p.m. Continued
- Rick Snyder
3:40 p.m. Continued
4:10 p.m. Continued

(18) WHOLESALE MARKETING

Fayette Room
Adam Watson, Presiding

- 1:30 p.m. GAP Update and Develop
ments /Q&A Third Party
Audits Grower Panel
2:00 p.m. Out-of-Season
Production for Farm-to-
School Markets
- Tim Coolong
2:30 p.m. Cider/Coffee Break
- Pre-Function and Lower
Atrium Areas
3:10 p.m. One-On-One Meeting with
Wholesalers
3:40 p.m. Continued
4:10 p.m. Continued

WHO'S WHO 2012

Ben Abell, UK Horticulturist,
Lexington, KY

Shadrick Adams, Food Manufacturing
Supervisor, Food Safety Branch, Dept.
of Public Health, Frankfort, KY

Rick Alexander, Agriculture Workforce
Management Assoc., Lexington, KY

Angela Anandappa, FSIC Program
Coordinator, UK Food Systems
Innovation Center, Lexington, KY

Larry Ayres, President, Kentucky State
Horticultural Society, Grower, Owenton,
KY

Richard Barnes, Trellis Growing
Systems, LLC, Fort Wayne, IN

Steve Berberich, UK Extension Associ-
ate for Floral Crops, Lexington, KY

Dr. Ric Bessin, UK Extension
Entomologist, Lexington, KY

Bill Best, Grower, Sustainable Mountain
Agricultural Center, Berea, KY

Dinah Bird, Baker-Bird Winery,
Augusta, KY

Susan & John Bond, Rock Springs
Vineyard & Winery, Grayson, KY

Larry Brandenburg, President, Organic
Assoc. of Kentucky, Grower, Harmony
Fields Farm, Shelbyville, KY

Bill & Sherry Buda, Generation Hill
Winery, Alexandria, KY

Angela Caporelli, Aquaculture Coord-
inator, Kentucky Dept. of Agriculture,
Frankfort, KY

Ty Cato, Shelby County Vegetable
Extension Associate, Univ. of Kentucky,
Shelbyville, KY

James Comer, KY
Commissioner of Agriculture
Frankfort KY

Dr. Tim Coolong, UK Extension Veg-
etable Specialist, Lexington, KY

Dan Crocker, Crocker Farm Winery,
Franklin, KY

Kyle Daniel, The Ohio State Univ.,
Columbus, OH

Andrea Dee, Kenton County UK
Extension Agent for Horticulture,
Covington, KY

Phil Desimone, Grimes Mill Winery,
Lexington, KY

Janet Eaton, Grower, President
KFMA, Wilmore, KY

Dr. Mike Ellis, Extension Plant Pa-
thologist, OARDC - Plant Pathology,
The Ohio State Univ., Wooster, OH

Kevan Evans, Grower, Evans Orchard
and Cider Mill, Georgetown, KY

Ed Fackler, Grower, New Salisbury,
IN

Vaden Fenton, Vegetable and Small
Fruit Extension Associate, UKREC,
Princeton, KY

Michael Fitzgerald, Organic Program
Coordinator, Division of Value Added
Plant Production, Kentucky Dept. of
Agriculture, Frankfort, KY

Sarah Fritschner, Betterworld-PR,
Louisville, KY

Steve Glisson, Glisson Vineyards &
Winery, Paducah, KY

Kristin Goodin, Barren County UK
Horticulture Extension Agent, Glas-
gow, KY

Dr. J. D. Green, UK Extension Weed
Specialist, Lexington, KY

Jeff Hall, Executive Director,
Kentucky Horticultural Council,
Louisville, KY

Lowell Hamilton, Breathitt County
UK Extension Agriculture and Natural
Resources Agent, Jackson, KY

Jay Hettmansperger, Garrard County
UK Extension Agricu-
ture and Natural Resources Agent, Lan-
caster, KY

Dr. Bob Houtz, Chair, UK Horticulture
Dept., Lexington, KY

Nathan Howell, Viticultural Techni-
cian, Western Kentucky Univ., Bowling
Green, KY

Kelly Jackson, Christian County
UK Extension Agent for Horticulture,
Hopkinsville, KY

Jeff Jones, Rural Development,
Lexington, KY

Donald Keller, Misty Meadow
Winery, Owensboro, KY

Jeff Kindhart, Senior Research Spe-
cialist, Dixon Springs Agricultural
Center, Simpson, IL

Lowell Land, President, Kentucky
Vineyard Society, Acres of Land
Winery, Richmond, KY

Dr. Andrew Landers, Cornell
Univ., Barton Laboratory, New York
Agricultural Experiment Station,
Geneva, NY

Kate Little, Resource Conservationist,
NRCS, Lexington, KY

Dr. Dave Lockwood, Extension Fruit
Specialist, Plant Sciences, Univ. of Ten-
nessee, Knoxville, TN

Anna Lucio, Marketing Specialist,
Division of Value Added Plant
Production, Kentucky Dept. of Agric.,
Frankfort, KY

Joe Luck, UK Engineer Associate,
Lexington, KY

Sean Lynch, UK Farm Technician,
Lexington, KY

WHO'S WHO

Joe Lutomske, New World Winery, Equipment, Springfield, MO

Ed Marchetti - AFTEK, Inc.,
Rochester, NY

Nancy McCormick, Grower, Blueberries of Daviess County, Utica, KY

Alicia McGuire, Executive Director, Kentucky Vineyard Society, Lexington, KY

Tommy McIntyre, McIntyre's Winery & Berries, Bardstown, KY

Dr. Diane Doud Miller, Associate Professor, Dept. of Hort. and Crop Science (OARDC), Wooster, OH

Jim Miller, MillaNova Winery, Mt. Washington, KY

John & Peggy Montgomery, Verona Vineyards, Verona, KY

Dennis Morgeson, Washington County UK Extension Horticulture Agent, Springfield, KY

Dr. Melissa Newman, UK Associate Professor, Lexington, KY

Eddie O'Daniel, President, Kentucky Wine Assoc., Springhill Winery & Plantation B 'n B, Bloomfield, KY

Conor O'Hara, 3M Purification Inc., Meriden, CT

Cindy Peake, Grower, Bramble Ridge Orchard, Mt. Sterling, KY

Dr. Kirk Pomper, Principal Investigator of Horticulture, Curator, USDA-National Clonal Germplasm Repository for Pawpaw, Kentucky State University, Frankfort, KY

Dr. Jozsef Racsko, Program Coordinator, Horticulture & Crop Science, OARDC, Wooster, OH

Dana Reed, Grower, Reed Valley Orchard, Paris, KY

Brett Reese, Shelby County UK Extension Agriculture and Natural Resources Agent, Shelbyville, KY

Dr. Edwin Ritchey, Extension Soil Specialist, UKREC, Princeton, KY

Glen Roberts, Wayne County UK Extension Agriculture and Natural Resources Agent, Monticello, KY

Dr. Kenny Seebold, UK Extension Plant Pathologist, Lexington, KY

Ben Shaffar, Kentucky Dept. of Agriculture, Frankfort, KY

Larry Snell, Executive Director, Kentucky Center for Cooperative Development, Elizabethtown, KY

Chris Smigell, UK Small Fruit and Vegetable Extension Associate, Lexington, KY

Dr. John Snyder, Teaching and Research, UK Horticulture Dept., Lexington, KY

Dr. Rick Snyder, Extension Specialist for Greenhouse and Field Vegetable Crops, Mississippi State Univ., Truck Crops Branch Experiment Station, Crystal Springs, MS

Dave Spalding, UK Vegetable Extension Associate, Lexington, KY

Crystal Sparks, UK Horticultural Technician, Robinson Station, Jackson, KY

Sharon Spencer, Farmers' Market Marketing Specialist, Kentucky Dept. of Agriculture, Frankfort, KY

Robert Stone, President Kentucky Vegetable Growers Assoc., Paris, KY

Dr. John Strang, UK Extension Fruit and Vegetable Specialist, Lexington, KY

Kim Strohmeier, Owen County UK Agriculture and Natural Resources Agent, Owenton, KY

Donna Stucker, Environmental Health Inspector Program Evaluator, Food Safety Branch, Dept of Public Health, Frankfort, KY

Ray Tackett, Bourbon County UK Extension Horticulture Agent, Paris, KY

Pam Upton, Blue Grass Tours, Lexington, KY

Gerry Van Der Meer, Commissioner of Kentucky State Parks, Frankfort, KY

Dr. Paul Vincelli, UK Extension Plant Pathologist, Lexington, KY

Dennis Walter, Chair, Kentucky Grape & Wine Council, StoneBrook Winery, Camp Springs, KY

Dr. Nicole Ward, UK Extension Plant Pathologist, Lexington, KY

Adam Watson, Fruit and Vegetable Marketing Specialist, Div. of Value Added Plant Production, KY Dept. of Agriculture, Frankfort, KY

Teresa & David Weyler, The Little Kentucky River Winery, Bedford, KY

Jeff Wheeler, UK Research Analyst, Lexington, KY

Dr. John Wilhoit, UK Extension Specialty Crop Mechanization Specialist, Lexington, KY

Patsy Wilson, UK Extension Viticulturist, Lexington, KY

Dr. Tim Woods, UK Agricultural Economics Extension Specialist, Lexington, KY

Dr. Shawn Wright, UK Extension Horticulture Specialist, Robinson Center for Appalachian Resource Sustainability, Jackson, KY

Dr. Annette Wszelaki, Commercial Vegetable Production Specialist, Plant Sciences Dept., Univ. of Tennessee, Knoxville, TN

Exhibitors 2012

All American Containers
216 Finley Rd.
Belle Vernon, PA 15012
phone: 315-585-6045
*rparmelee@allamerican
containers.com*

Arton Products
PO Box 340
Lively, VA 22507
Phone: (804) 462-5800 ext. 115
roberts@artonproducts.com

Brandt Consolidated Inc.
2935 So. Koke Mill Rd.
Springfield, IL 62711
Phone: 217-891-3651
brad.engel@brandt.co

Brick Packaging
1677 Park Drive
Traverse City, MI 49686
phone: 231-947-4950
danbrick@brickpackaging.com

Bunton Seed Company
939 E. Jefferson St.
Louisville, KY 40206
phone: 502-584-0136
pam@buntonseed.com

Charles Compost
1195 Hwy 815
Calhoun, KY 42327
phone: 270-499-1435
charlescompost@gmail.com

Clifton Seed Company
P.O. Box 206
Faison, NC 28341
phone: 910-260-0252
edr@cliftonseed.com

Continental Industries
P.O. Box 865
Shepherdsville, KY 40165
phone: 502-543-2600
jchamilton@windstream.net

Criveller Company
6935 Oakwood Dr.
Niagara Falls, ON L2E655
phone: 905-357-2930
dmacoretta@criveller.com

Crops Diversification & Biofuel Res. & Ed. Ctr.
N-318 Ag. Science Bldg. North
University of KY
Lexington, KY 40546
phone: 859-257-1477
cgcass0@uky.edu

Deerfield Supplies
2825 Stringtown Rd.
Elkton, KY 42220
phone: 270-265-2425

Dillman Farm, Inc.
4955 West State Road 45
Bloomington, IN 47403
phone: 812-825-5525
carydillman@dillmanfarm.com

Double A Vineyards, Inc.
10277 Christy Rd.
Fredonia, NY 14063
phone: 716-672-8493
sue.rak@doublevineyards.com

Fresh Start Growers Supply
1007 East Jefferson Street
Louisville, KY 40206
phone: 502-442-7883
steve@freshstartgrowers.com

Governor's Office of Ag. Policy
404 Ann Street
Frankfort, KY 40601
phone: 502-564-4627
sandra.gardner@ky.gov

H & H Farm Machine Co., Inc.
7916 Unionville-Brief Rd.
Monroe, NC 28110
phone: 704-753-4919
hhspray@vnet.net

Hillside Orchard Farms
105 Mitcham Circle
Tiger, GA 30576
phone: 706-752-4995
lynn@hillsideorchard.com

Indiana Berry & Plant Co.
5218 W. 500 S
Huntingburg, IN 47542
phone: 812-683-3055
inberry@psci.net

Innovative Labeling Solutions
4000 Hamilton Middletown Rd.
Hamilton, OH 45011
phone: 513-526-6655
ottoknop@ilslables.com

Jackto/Richey Equipment
3213 Honeysuckle
White Pine, TN 37890
phone: 865-674-6042
sales@richeyequipment.com

KY Department of Agriculture
100 Fair Oaks Lane, 5th Floor
Frankfort, KY 40601
phone: 502-564-4983
stacia.alford@ky.gov

Kentucky Farm Bureau
Roadside Farm Market Program
9201 Bunsen Parkway
Louisville, KY 40220
phone: 502-495-5106
kara.keeton@kyfb.com

Kentucky Irrigation Co.
340 Midland Place
Lexington, KY 40505
phone: 859-254-7022
bob@kentuckyirrigation.com

**Kentucky State University
Fruit and Vegetable Mobile
Processing Initiative**
129 Atwood Research Facility
Frankfort, KY 40601
phone: 502-597-5942

Lincoln Co. Produce Auction
450 Al Wyler Rd.
Crab Orchard, KY 40419
phone: 606-355-0020

Midwest Vineyard Supply
2300 South Twin Bridge Road
Decatur, IL 62521
phone: 217-864-9896
sales@midwestvineyardsupply.com

Miller Chemical & Fertilizer Corp.
P.O. Box 333
Hanover, PA 17331
phone: 618-525-1818
rabbit_grape@yahoo.com

Premium Hort Supply Co.
915 E. Jefferson St.
Louisville, KY 40206
phone: 502-582-3897
premort@bellsouth.net

Rockford Package Supply
10421 Northland Dr.
Rockford, MI 49341
phone: 800-444-7225
hpaulson@rockfordpack.com

Rupp Seeds Inc.
17919 County Road B
Wauseon, OH 43567
phone: 1-800-700-1199
philk@ruppseeds.com

Scott Laboratories
P.O. Box 4559
Petaluma, CA 94955
phone: 707-765-6666
zacks@scottlab.com

Seedway, LLC
7520 Ruggles Ferry Pike
Knoxville, TN 37924
phone: 865-548-7333
kbhosey@gmail.com

Smith's Promotional Products
1474 Nivevah Rd.
Frankfort, KY 40601
phone: 502-227-7829
dtsmith59@aol.com

Southern FS
200 Jamestown Rd.
Cobden, IL 62920
phone: 618-893-4852
*SouthernFS@cobden@
charter.com*

Spec Trellising Co.
39 Indian Drive, P.O. Box 2204
Ivyland, PA 18974
phone: 1-800-237-4594
info@spectrellising.com

**Town & Country Specialty
Foods, Inc.**
P.O. Box 847
Bardstown, KY 40004
phone: 502-507-2974
foods@bardstowncable.net

Trellis Growing Systems, LLC
2427 S. Hadley Rd.
Ft. Wayne, IN 46804
phone: 260-241-3128
rcbarnes@trellisgrowingsystems.com

**Wabash Valley Progressive
Viticulture**
8902 S. 625 W
Rosedale, IN 47874
phone: 765-548-0676
jbditzler@gmail.com

**Waters Agricultural
Laboratories, Inc.**
2101 Calhoun Rd., Hwy 81
Owensboro, KY 42301
phone: 270-685-4039
jeff@watersag.com

2nd Floor

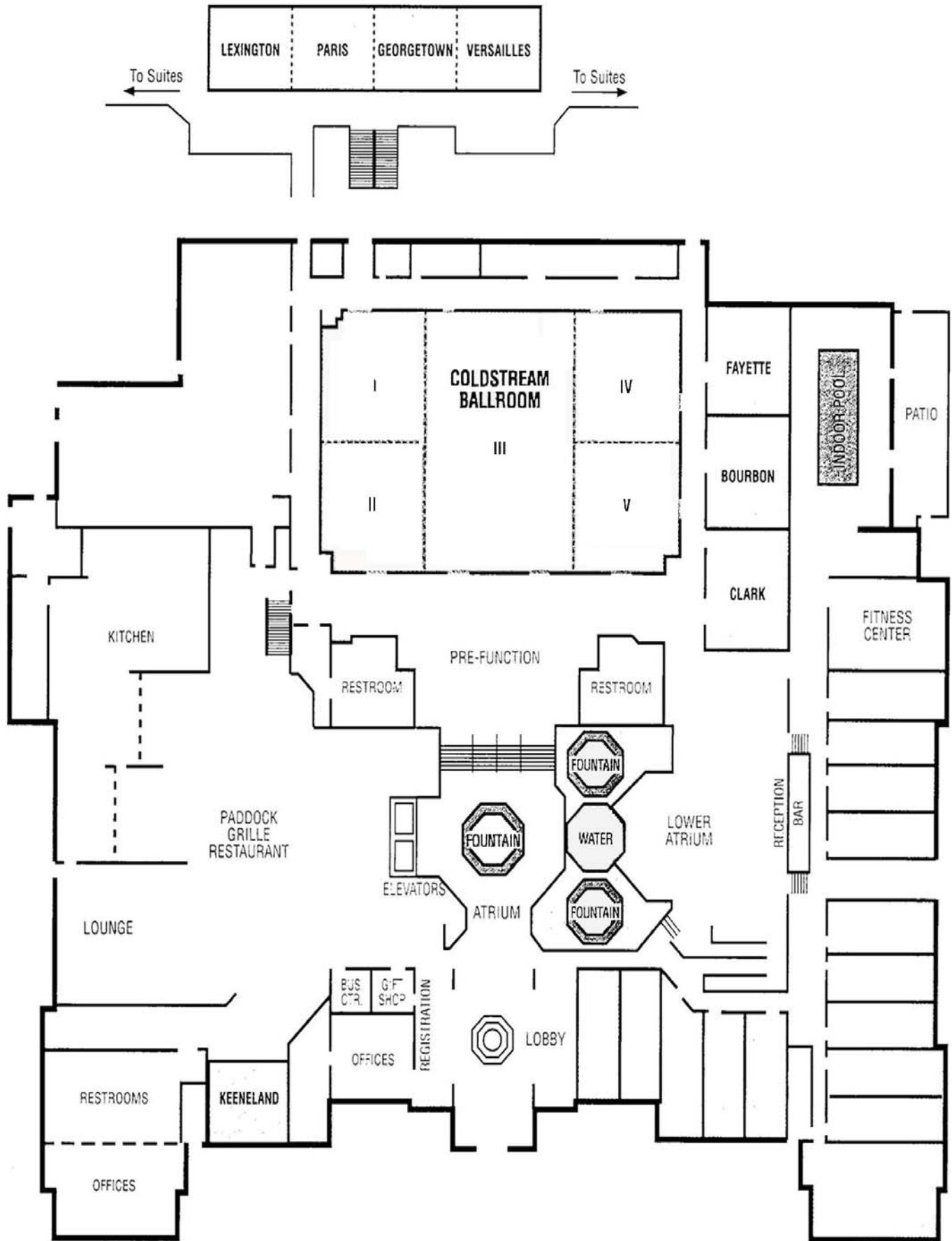

Kentucky State Horticultural Society
UK Research & Education Center
P.O. Box 469
Princeton KY 42445-0469

DIRECTIONS

From I-75/64: Take Exit 115 then right on to Newtown Pike. Turn right onto Aristides Blvd. at the UK Coldstream Research Campus. Hotel is on the right.

From Blue Grass Airport: Exit left on to Man O'War Blvd. to Versailles Rd. Turn right onto Versailles Rd. Take Rt. 4 New Circle Rd. north to Newtown Pike Exit North. Turn left onto Aristides Blvd. at the UK Coldstream Research Campus. Hotel is on the right.

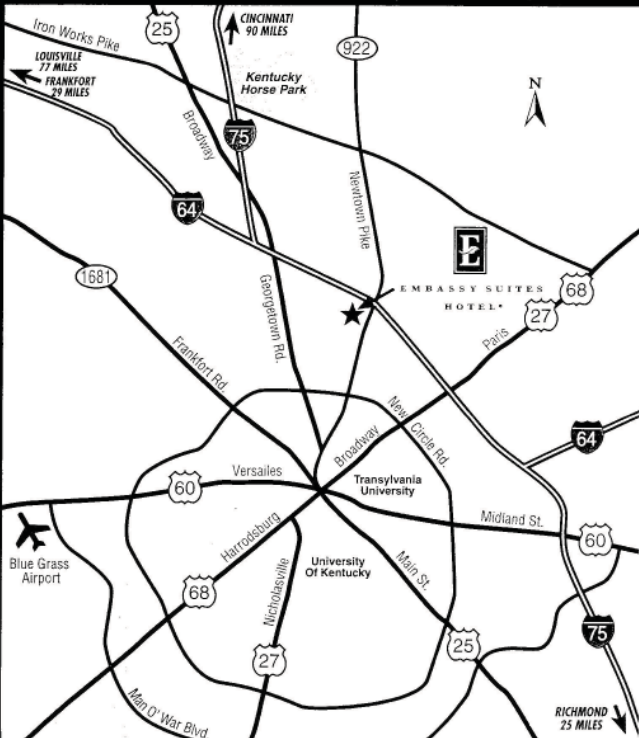

KENTUCKY FRUIT AND VEGETABLE CONFERENCE
Embassy Suites Hotel, Lexington KY -- January 5-6, 2012

Mark one: _____ ADVANCE REGISTRATION _____ I am not able to attend--continue my membership(s) as listed below.

NAME(S) for name tag (Please print) _____

ADDRESS _____

CITY, STATE _____ ZIP _____

PHONE: (_____) _____ OCCUPATION/FIRM _____

FAX: (_____) _____ E-Mail _____

PLEASE LIST NAME(S) OF ADDITIONAL REGISTRANTS: _____

I recommend _____ for the KSHS or KVGA Board of Directors.

Complimentary registration for County Extension Agents, University Students, and children under 15 years of age accompanying an adult.

**** A \$30 registration allows entrance into any conference meeting session.**

One year membership plus meeting registration. **\$30 PER PERSON**

Kentucky State Horticultural Society ----- Number attending _____

Kentucky Vegetable Growers Association ----- Number attending _____

Organic Association of Kentucky ----- Number attending _____

Grape & Wine Short Course, Jan. 6 ----- Number attending _____

[Meeting registration only -- does not include organization membership.]

\$30 each x Total number attending _____ = TOTAL \$ _____

KVS Membership Renewal and New Member Fee -- \$25 x Number attending _____ = TOTAL _____

Register for the **Celebration of Kentucky Wines**, Jan. 5, 2012 / 5:00-6:00 PM

Number attending _____ x \$15 each = TOTAL \$ _____

****Meal tickets are available only through advance registration.**

EXHIBITOR/GROWER LUNCHEON -- January 5, 2012 / 12:00 Noon EST

MENU: *All American Deli Buffet -- roast beef, smoked turkey, ham, cheeses, cole slaw, mustart potato salad, chefs dessert selection*

Number attending _____ x \$26 each = TOTAL \$ _____

AWARDS LUNCHEON - January 6, 2012 / 11:45 p.m. EST

MENU: *KY Original Buffet -- roasted corn chowder, market salad topped with toasted pecans, roast pork with bourbon glaze, buttermilk fried chicken, bourbon whipped sweet potatoes, country green beans, warm corn break, KY Derby Pie, KY bread pudding and fruit pies*

Number attending _____ x \$33 each = TOTAL \$ _____

→ **Please make CHECKS payable to: KENTUCKY FRUIT AND VEGETABLE CONFERENCE**

CHECK # _____ CHECK AMT \$ _____ CASH AMT \$ _____ TOTAL PAID \$ _____

Mail advance registration to:

Mary Ann Kelley, Research & Education Center,
 PO Box 469, Princeton, KY 42445-0469
 Phone: 270-365-7541 x 216; Fax: 270-365-2667



Dr. John Strang, Coordinator

ADVANCE REGISTRATION MUST BE RECEIVED BY MONDAY, DECEMBER 20, 2011