

# 2010 Kentucky Fruit and Vegetable Conference and Trade Show

JANUARY 4-5, 2010

Monday and Tuesday

Kentucky State Horticulture Society  
154th Annual Meeting

-----

Kentucky Vegetable Growers Association  
39th Annual Meeting

-----

Kentucky Farmers' Market Association  
4th Annual Meeting

-----

Organic Association of Kentucky  
1st Annual Meeting

-----

Midwest Apple Improvement Association

-----

The Kentucky Grape and Wine Short Course

*In cooperation with:  
University of Kentucky  
College of Agriculture  
Kentucky State University  
Kentucky Department of Agriculture*

Meeting Place:  
Embassy Suites Hotel  
1801 Newtown Pike  
Lexington, Kentucky 40511  
(859) 455-5000  
FAX (859) 455-5122  
Reservations: 800-EMBASSY

# Meeting Outline

## Sunday, January 3

## Room

4:00-6:00 pm	Pre-conference Record Keeping Training .....	Coldstream 2
6:00-8:00 pm	Pre-conference Reception and Kentucky Farmers' Market Association Annual Meeting .....	Coldstream 4 & 5
6:00 pm	Midwest Apple Improvement Association Board Meeting .....	Lobby
7:00-9:00 pm	Exhibitor Set-up	
7:30-9:30 pm	Preconference Fruit Round Table Discussion .....	Bourbon

## Monday, January 4

8:00 am	Exhibits Open	
8:50 am	KSHS-KVGA Joint Session .....	Coldstream 3
10:30 am	Break	
Noon	Exhibitors & Growers Luncheon .....	Coldstream 1 & 2
1:30 pm	<b><u>Concurrent Sessions</u></b>	
	Winemaking .....	Coldstream 1 & 2
	Vegetable Production .....	Coldstream 3
	Farmers' Markets .....	Coldstream 4
	Midwest Apple Improvement Association and Commercial Tree Fruit.....	Coldstream 5
2:30 pm	Break	
4:40 p.m	MAIA Apple Tasting .....	Fayette
5:15 pm	Exhibits Close	
5:00 pm	Celebration of Kentucky Wines .....	Coldstream 1 & 2
6:30 pm	Banquet .....	Coldstream 3

## Tuesday, January 5

8:00 am	Exhibits Open	
8:30 am	<b><u>Concurrent Sessions</u></b>	
	Grape & Wine Short Course .....	Coldstream 1 & 2
	Vegetable Production .....	Coldstream 3
	Organic Farming and Gardening .....	Coldstream 4
	Tree Fruit .....	Coldstream 5
	Food Safety - Good Agricultural Practices Training .....	Bourbon
10:00 am	Break	
11:40 am	Lunch on Your Own	
1:30 pm	<b><u>Concurrent Sessions</u></b>	
	Grape & Wine Short Course .....	Coldstream 1 & 2
	Direct Marketing .....	Coldstream 3
	Woody Cut Stems .....	Coldstream 4
	Small Fruit Production .....	Coldstream 5
	Food Safety - Third Party Audit Preparation .....	Bourbon
	OAK First Annual Meeting .....	Fayette
2:30 pm	Break	
3:00 pm	Exhibit Hall Closes	

Dear Fruit and Vegetable Growers:

The 2010 Kentucky Fruit and Vegetable Conference and Trade Show will again be at the Embassy Suites Hotel, Lexington, KY, Monday and Tuesday, January 4 and 5, 2010. Highlights of this year's meeting will be a pre-conference Record Keeping Training, a Midwest Apple Improvement Association session where new selections can be tasted, and sessions on Farmers' Markets, Commercial Fruit and Vegetable Production, Small Fruit Production, Organic Farming and Gardening, Woody Cut Stems, the Grape and Wine Short Course, Winemaking, Marketing, Food Safety - Good Agricultural Practices Training and Third Party Audit Preparation. We have many excellent out-of-state speakers this year.

The KVS will have an optional Celebration of Kentucky Wines featuring Kentucky wines prior to the banquet. Drew Graham, Assistant to the Dean, Director of Advancement, UK College of Agriculture, Lexington, KY will speak on Interacting with the Kentucky Legislature and Dr. Thomas Barnes, U.K. Extension Wildlife Specialist will provide an entertaining discussion of Wildflower Myths and Realities at the banquet.

We will have a Trading Post bulletin board to sell used equipment. If you are looking for equipment buyers, bring along a description containing your name, phone number and the equipment price.

PLEASE make your room reservations directly with the hotel. Our block of rooms will be held until Jan. 1, 2010. Be sure to let the hotel know that you will be staying for the Kentucky Fruit and Vegetable Conference to obtain our special suite room rate (they are all suites) of \$109.00. This includes an evening managers reception with drinks and a full cooked-to-order breakfast daily. We encourage growers to stay at Embassy Suites Hotel to support meeting overhead expenses. Note: if the hotel parking lot is full, meeting attendees may park along Aristides Street in front of the hotel.

The \$30 meeting registration fee includes a year's membership in the KVGA, KSHS or OAK and entrance into the Midwest Apple Improvement Association session or Grape & Wine Short Course. Membership in the KVGA also allows growers to use pesticides that have received 24c registrations for Kentucky. Please see the registration form to become a member of the Kentucky Vineyard Society and to sign up for the meal functions and the Celebration of Kentucky Wines.

The enclosed registration form enables you to register in advance so your tickets and name tags will be ready for you when you arrive at the meeting. **NOTE: WE STRONGLY URGE YOU TO PRE-REGISTER. BANQUET AND LUNCHEON TICKETS CAN ONLY BE PURCHASED BY ADVANCE REGISTRATION. NAME BADGES WILL BE REQUIRED TO ENTER MEETING ROOMS. PRE-REGISTRATION FORMS NEED TO BE IN OUR HANDS BY FRIDAY DECEMBER 18, 2009.** If you would like to serve on the KVGA or KSHS boards of directors or would like to nominate another member, please designate this on your registration sheet.

If circumstances are such that you cannot attend the meeting, please complete and return the form to Ms. Mary Ann Kelley, Research & Education Center, P.O. Box 469, Princeton, KY 42445 to continue your association membership.

Sincerely

Robert Stone, President  
KY Vegetable Growers Association

Larry Ayres, President  
KY State Horticultural Society

**KENTUCKY STATE HORTICULTURAL  
SOCIETY OFFICERS**

President: Larry Ayres, Owenton  
Vice-Presidents: Cal Blake, Lexington  
Kevan Evans, Georgetown  
Linda Ison, Crestwood  
Billy Reid, Owensboro  
Don Haney, Nancy  
Paul Tokosh, Pleasureville  
Bill Jackson, Bowling Green  
Julie Lovell, Hopkinsville  
Jim Moore, Bowling Green  
Donald Davis, South Shore  
Joanna Hinton, Hodgenville  
Terry Peake, Mt. Sterling

Secretary: Doug Archbold, Lexington  
Treasurer: Cindy Peake, Mt. Sterling

Advisors: Rick Durham, Lexington  
Ed Fackler, New Salisbury, IN  
Kirk Pomper, Frankfort  
John Strang, Lexington

**KENTUCKY VEGETABLE GROWERS  
ASSOCIATION OFFICERS**

President: Robert Stone, Paris  
Vice-President: Butch Case, Cynthiana  
Secretary: Beth Wilson, Nancy  
Treasurer: Kevin Trunnel, Utica  
Directors: Larry Snell, Elizabethtown  
Joel Wilson, Nancy  
John Bell, Georgetown  
Judi Blake, Lexington  
Bill Holleran, Jr., Lexington  
Brent Lackey, Somerset  
Zeldon Angel, Winchester  
Annette Meyer-Heisdorffer, Owensboro  
C.A. Pantle, Jr., Owensboro  
Linda McMaine, Salvisa

Advisors: Tim Coolong, Lexington  
Terry Jones, Quicksand  
Mac Stone, Frankfort  
John Strang, Lexington

**KENTUCKY VINEYARD SOCIETY  
ASSOCIATION OFFICERS**

President: Zane Burton, Somerset  
Vice-President: Dennis Walter, Melbourne

Treasurer: Chuck Smith, New Castle  
Directors: Peter Boone, Springfield  
Jim Hatchett, Springfield  
Mike Hatzell, Louisville  
Bob Karsner, Willisburg  
Bruce Kunze, Utica  
Roger Leasor, Lexington  
Lowell Land, Richmond  
Chad Peach, Frankfort  
Joey Sloan, Lawrenceburg

Advisor: Chris Smigell, Lexington

All Times Are Eastern Standard Time

## SUNDAY, JANUARY 3

- 4:00 - 6:00 pm      **PRECONFERENCE RECORD KEEPING TRAINING**  
(Creating financial records, managing business bank account, tracking expenses and revenues, invoicing and paying bills)  
*Coldstream 2 Room, Nathan Routt, Conducting Training*
- 6:00 - 8:00 pm      **PRECONFERENCE RECEPTION AND KENTUCKY FARMERS' MARKET ASSOCIATION ANNUAL MEETING**  
*Coldstream 5 Room, Janet Eaton, Presiding*
- 6:00 pm              MAIA Board Meeting, Hotel Lobby across from registration desk
- 7:00-10:00 pm      Exhibitor Set-up -- Pre-Function Area & Lower Atrium
- 7:30 - 9:00 pm      **PRECONFERENCE FRUIT ROUND TABLE DISCUSSION**  
*Bourbon Room, John Strang, Presiding*

## MONDAY MORNING, JANUARY 4

- 8:00 am      Exhibits Open, Pre-Function & Lower Atrium Areas  
8:00 am      Registration, Pre-Function area outside meeting rooms  
Meeting registration \$30.00. Please see the registration form for association membership.

### (1) KSHS - KVGA JOINT SESSION

*Coldstream 3 Room*  
*Robert Stone, Presiding*

### (2) KENTUCKY GRAPE & WINE COUNCIL MEETING

*Bourbon Room*  
*Dennis Walter, Presiding*

- 8:45 am      Welcome - *Larry Ayres*
- 8:55 am      Horticulture Department Update - *Bob Houtz*
- 9:00 am      Horticulture Council Update - *Jeff Hall*
- 9:15 am      Kentucky Department of Agriculture Produce Marketing Update - *Mac Stone*
- 9:30 am      Early Season Tomato Production in High Tunnels  
- *Annette Wszelaki*
- 10:00 am      Energy-Smart Horticulture - *Michael Bomford*
- 10:30 am      Cider/Coffee Break and Visit Exhibits  
- Pre-Function and Lower Atrium Areas
- 11:00 am      Kentucky Mesonet Disease and Insect Prediction System  
- *Tom Priddy, John Hartman and John Strang*
- 11:15 am      Governors Office of Agricultural Policy Program Update - *Roger Thomas*
- 11:30 am      Grasshopper Marketing - *Jim Earley*
- 10:00 am      Meeting begins
- 10:30-11:00 am      Cider/Coffee Break and Visit Exhibits  
- Pre-Function and Lower Atrium Areas

12:00 noon      **EXHIBITORS AND GROWERS LUNCHEON** - Coldstream 1 & 2 Rooms

### 12:00 noon.      **KVGA AND KSHS BOARD MEETINGS**

*Kentucky State Horticultural Society - Paris Room*  
*Kentucky Vegetable Growers Association - Georgetown Room*

Board members should pick up their lunch at the buffet in Coldstream 1 & 2 and then meet in the designated room at the top of the stairs located over the meeting rooms.

## 4 CONCURRENT SESSIONS

Concurrent sessions will enable participants to attend topics of interest in different sessions.

### MONDAY AFTERNOON, JANUARY 4

#### (3) WINEMAKING

*Coldstream 1 & 2 Rooms*  
*Jeff Wheeler, Presiding*

- 1:30 pm What are Wine Sales All About  
- *Donniella Winchell*
- 2:00 pm Brett Awareness and Detection  
- *Paul Vincelli*
- 2:30 pm Cider/Coffee Break and Visit Exhibits  
- Pre-Function and Lower Atrium Areas
- 3:10 pm Crucial Safe Wine Making Practices  
- *Tom Cottrell*
- 3:40 pm Wine Tasting  
- *Tom Cottrell and Patsy Wilson*

#### (4) VEGETABLE PRODUCTION

*Coldstream 3 Room*  
*Nathan Howard, Presiding*

- 1:30 pm Snap Bean Production  
- *Annette Wszelaki*
- 2:00 pm Vegetable Cultivar Trial Results  
[Staked Tomatoes, Cucumbers, Beets, Super Sweet Corn, Fall Tomatoes] - *Crystal Sparks, Dave Spalding, Amy Poston Lentz, and Vaden Fenton*
- 2:30 Cider/Coffee Break and Visit Exhibits  
- Pre-Function and Lower Atrium Areas
- 3:10 pm Soil Solarization and Cover Crops for  
Suppression of Soil Borne Pests  
- *Shubin Saha*
- 3:40 pm Continued
- 4:10 pm Late Blight, Downy Mildew, and Powdery  
Mildew Disease Management  
- *Kenny Seebold*

### MONDAY EVENING, JANUARY 4

5:00 pm **Exhibits Close**

#### 5:00 pm **CELEBRATION OF KENTUCKY WINES**

*Featuring the Evaluation of Commercial Kentucky Products*  
- *Coldstream 1 & 2 Rooms*

Sponsored by the KVS. The cost is \$10.00 for the tasting. (Acres of Land Winery, Chrisman Mill Vineyard, Equus Run, Lovers Leap Winery, River Bend Winery, Sinking Valley Vineyard & Winery, Smith-Berry Vineyard & Winery, StoneBrook Winery, Talon Winery)

6:30 pm **BANQUET**, Coldstream 3 Room  
*Larry Ayres, Presiding*

**Speaker:** *Interacting with the Kentucky Legislature*

Drew Graham - Assistant to the Dean, Director of Advancement, UK College of Agriculture

**Entertainment:** *Wildflower Myths and Realities*

Dr. Tom Barnes

This program was funded in part by the Kentucky Humanities Council, Inc. and the National Endowment for the Humanities

## MONDAY AFTERNOON, JANUARY 4

### (5) FARMERS' MARKETS

*Coldstream 4 Room*  
*Sharon Spencer, Presiding*

- 1:30 pm How EBT and Debit Impacted Kentucky Farmers' Markets  
- *Janet Eaton and Tim Woods*
- 2:00 pm Economic Impact of Sampling at The Farm Market  
- *Janet Eaton and Tim Woods*
- 2:30 pm Cider/Coffee Break and Visit Exhibits  
- Pre-Function and Lower Atrium Areas
- 3:10 pm Sweet Potato Production  
- *Tim Coolong*
- 3:55 pm Mulching with a Round Bale Unroller  
- *John Wilhoit*
- 4:10 pm Using Antioxidants in Small Fruit as a Marketing Tool  
- *John Strang*

### (6) MIDWEST APPLE IMPROVEMENT ASSOCIATION & COMMERCIAL TREE FRUIT

*Coldstream 5 Room*  
*Felix Cooper, Presiding*

- 1:30 pm MAIA Update and Look to The Future  
- *Mitch Lynd*
- 2:00 pm Pruning No-Ladder Peaches  
- *Lester Lynd*
- 2:30 pm Cider/Coffee Break and Visit Exhibits  
- Pre-Function and Lower Atrium Areas
- 3:10 pm Dwarf Apple Production via Benign Neglect  
- *Dick Wander*
- 3:40 pm U-Pick at Lynd Fruit Farm  
- *Mitch Lynd*
- 4:10 pm Evaluation Protocol of New Apples by IFO  
- *Emmanuel de Lapparent*
- 4:40 pm Apple Taste Evaluation (Bourbon Room)  
- *Diane Miller*

## TUESDAY, JANUARY 5 -- 5 CONCURRENT SESSIONS

Concurrent sessions will enable participants to attend topics of interest in different sessions.

8:00 am Exhibits Open, Pre-Function & Lower Atrium Areas  
8:00 am Registration, Pre-Function area outside meeting rooms

### (7) GRAPE & WINE SHORT COURSE

*Coldstream 1 & 2 Rooms  
Zane Burton, Presiding*

### (8) VEGETABLE PRODUCTION

*Coldstream 3 Room  
Philip Konopka, Presiding*

### (9) ORGANIC FARMING AND GARDENING

*Coldstream 4 Room  
Michael Fitzgerald, Presiding*

8:55 am	Welcome Address - <i>Zane Burton</i>	8:30 am	Grower Vegetable Demonstration Plot Results - <i>Nathan Howard, Nathan Howell, &amp; Dave Spalding</i>	8:30 am	Cucumber Beetle Control in Muskmelons - <i>Bob Caudle</i>
9:00 am	12-Year Cultivar Update - <i>Paul Read</i>	9:00 am	KVGA Annual Business Meeting	9:00 am	Corn Earworm Control with Pheromones and Organic Apple Production Concerns - <i>John Sedlacek &amp; Delia Scott</i>
9:30 am	Grape Production Issues: Round Table Discussion (Question & Answer Session) - <i>Cathy Edwards, Bob Karsner, Brandon O'Daniel &amp; John Hartman</i>	9:30 am	Melon Trials - <i>Shubin Saha</i>	9:30 am	Organic Question and Answer Session - <i>Mike Bomford, Sean Clark and Ben Abell</i>
10:00 am	Cider/Coffee Break and Visit Exhibits	10:00 am	Cider/Coffee Break and Visit Exhibits	10:00 am	Cider/Coffee Break and Visit Exhibits
10:40 am	Grape Disease Diagnostics and Uncommon Problems - <i>Julie Beale and Chris Smigell</i>	10:40 am	Weed Control Management Strategies for Vegetables - <i>Shawn Wright</i>	10:40 am	Vegetable Problem and Beneficial Insect ID - <i>Ric Bessin</i>
11:10 am	Cultural Practices to Manage Bunch Rot Diseases - <i>Jeff Wheeler</i>	11:10 am	Plasticulture Sweet Corn Production - <i>Darrell Slone</i>	11:10 am	Organic Association of KY (OAK) Organization - <i>Larry Swetnam</i>
11:40 am	LUNCH ON YOUR OWN	11:40 am	LUNCH ON YOUR OWN	11:40 am	LUNCH ON YOUR OWN

### (12) GRAPE AND WINE SHORT COURSE

*Coldstream 1 & 2 Rooms  
Patsy Wilson, Presiding*

### (13) DIRECT MARKETING

*Coldstream 3 Room  
Kristen Branscum, Presiding*

### (14) WOODY CUT STEMS

*Coldstream 4 Room  
Patty Meads & Andrea Dee, Presiding*

1:30 pm	IPM: Grape Berry Moth and Grape Root Borer - <i>Ric Bessin</i>	1:30 pm	Community Supported Agriculture (CSA) Direct Marketing Tools for Producers Interested in Starting or Expanding A CSA Program	1:30 pm	New Varieties for 2011 - <i>John Veigel</i>
2:00 pm	Developing a Relationship between Growers and Wineries (Q & A session) - <i>Dominique Brousseau, Jim Wight, Bruce Kunze and Tim Woods</i>	2:30 pm	Cider/Coffee Break and Visit Exhibits	2:00 pm	Market Bouquet Design & Wholesale Opportunities - <i>Sharon Bale</i>
2:30 pm	Cider/Coffee Break and Visit Exhibits	3:10 pm	Social Media: It's Free, But Is It Worth It?: Do you Twitter? Do You Have A Facebook Page... You Tube? Who Has the Time for Social Media? Find Out How to Use Social Media Tools to Benefit Your Farm in an Expense-free, Time-efficient Way and Create Brand Loyalty with Your Consumers	2:30 pm	Cider/Coffee Break and Visit Exhibits
3:10 pm	Challenges in the Vineyard - <i>Paul Read</i>	3:40 pm	Managing Cut Stem Pests - <i>Ric Bessin</i>	3:10 pm	Growing Great Transplants - <i>Rebecca Schnelle</i>
3:40 pm	Disease Management Failure - <i>Chris Smigell</i>	4:10 pm	Diseases of Cut Stems - <i>Julie Beale</i>		
4:10 pm	State of the Industry - <i>Mac Stone and Dennis Walter</i>				

## TUESDAY, JANUARY 5 -- 5 CONCURRENT SESSIONS

Concurrent sessions will enable participants to attend topics of interest in different sessions.

8:00 am Exhibits Open, Pre-Function & Lower Atrium Areas  
8:00 am Registration, Pre-Function area outside meeting rooms

### (10) TREE FRUIT

*Coldstream 5 Room  
Dwight Wolfe, Presiding*

8:30 am Tree Fruit Spray Guide Update  
- Ric Bessin, John Hartman and John Strang  
9:00 am Peach Pruning Systems  
- \*Dave Lockwood  
9:30 am NC-140 Rootstock Trial Results Summary  
- Doug Archbold and Dwight Wolfe  
10:00 am Cider/Coffee Break and Visit Exhibits  
10:40 am Tree Fruit Maturation and Harvest Physiology  
- John Strang  
11:10 am KSHS Annual Business Meeting  
11:40 am LUNCH ON YOUR OWN

### (11) FOOD SAFETY - GOOD AGRICULTURAL PRACTICES TRAINING

*(For direct marketers)  
Bourbon Room*

*Adam Watson, Presiding*  
8:30 am Produce Safety, Soil, Manure and Wild Animal Concerns  
- Bonnie Sigmon  
9:00 am Worker Hygiene and Health  
- Bonnie Sigmon  
9:30 am Water, Contaminants, Containers and Produce Handling  
- Bonnie Sigmon  
10:00 am Cider/Coffee Break and Visit Exhibits  
10:40 am Records, Produce Sampling and Questions  
- Adam Watson  
11:10 am Rules and Regulations for Home Based Processing  
- Shadrick Adams  
11:40 am LUNCH ON YOUR OWN

### (15) SMALL FRUIT PRODUCTION

*Coldstream 5 Room  
Robbie Smith, Presiding*

1:30 pm Blueberry Production Basics  
- Dave Lockwood  
2:00 pm Phytophthora Root Rot in Blueberries - John Hartman  
2:30 pm Cider/Coffee Break and Visit Exhibits  
3:10 pm Plasticulture Strawberry Production  
- Shawn Wright  
3:40 pm High Tunnel Strawberry Production  
- Shawn Wright  
4:10 pm Primocane Fruiting Blackberries  
- Kirk Pomper

### (16) FOOD SAFETY - THIRD PARTY AUDIT PREPARATION (For growers selling to large wholesalers that require this)

*Bourbon Room  
Mac Stone, Presiding*

1:30 pm Round Table Discussion  
2:30 pm Cider/Coffee Break and Visit Exhibits

### (17) ORGANIC ASSOCIATION OF KENTUCKY FIRST ANNUAL MEETING

*Fayette Room  
Larry Swetnam, Presiding*

1:30 pm Round Table Discussion  
2:30 pm Cider/Coffee Break and Visit Exhibits

# WHO'S WHO

**Ben Abell**, Horticulturist, Department of Horticulture, University of Kentucky, Lexington, KY

**Shadrick Adams**, Technical Consultant, Kentucky Food Safety Branch, Frankfort, KY

**Harriet Allen**, Talon Winery, Lexington, KY

**Dr. Douglas Archbold**, Teaching and Research, University of Kentucky, Department of Horticulture, Lexington, KY

**Larry Ayres**, President Kentucky State Horticultural Society, Grower, Owenton, KY

**Sharon Bale**, Extension Floriculturist, Department of Horticulture, University of Kentucky, Lexington, KY

**Dr. Tom Barnes**, Extension Wildlife Specialist, Department of Forestry, University of Kentucky, Lexington, KY

**Dr. Ric Bessin**, Extension Entomologist, Department of Entomology, University of Kentucky, Lexington, KY

**Julie Beale**, Plant Diagnostician, Department of Plant Pathology, University of Kentucky, Lexington, KY

**Cynthia Bohn**, Equus Run Vineyards, Midway, KY

**Dr. Michael Bomford**, Organic Project Leader, Atwood Research Facility, Kentucky State University, Frankfort, KY

**Dominique Brousseau** - Winemaker, Chateau du Vieux Corbeau, Danville, KY

**Kristen Branscum**, Division Director, Division of Value Added Plant Production, Kentucky Department of Agriculture, Frankfort, KY

**Zane Burton**, President Kentucky Vineyard Society, Grower, Sinking Valley Vineyard & Nursery, Somerset, KY

**Bob Caudle**, Graduate Student, Department of Horticulture, University of Kentucky, Lexington, KY

**Dr. Sean Clark**, Chairperson, Associate Professor Ag and Natural Resources, Agricultural & Natural Resources Department, Berea College, Berea, KY

**Dr. Tim Coolong**, Extension Vegetable Specialist, Department of Horticulture, University of Kentucky, Lexington, KY

**Felix Cooper**, Director of Research and Development, Gardens Alive! Inc., Tipp City, OH

**Dr. Tom Cottrell**, Extension Enologist, Department of Horticulture, University of Kentucky, Lexington, KY

**Andrea Dee**, Kenton County Extension Agent for Horticulture, Covington, KY

**Vaden Fenton**, Vegetable & Small Fruit Extension Associate, University of Kentucky, Research & Education Ctr., Princeton, KY.

**Drew Graham** - Assistant to the Dean, Director of Advancement, UK College of Agriculture, University of Kentucky, Lexington, KY

**Janet Eaton**, Grower, Wilmore, KY

**Jim Earley**, Manager, Grasshoppers Distribution, Louisville, KY

**Cathy Edwards**, Harkness Edwards Vineyard, Winchester, KY

**Michael Fitzgerald**, Organic Program Coordinator, Division of Value Added Plant Production, Kentucky Department of Agriculture, Frankfort, KY

**Jeff Hall**, Executive Director, Kentucky Horticultural Council, Louisville, KY

**Dr. John Hartman**, Extension Plant Pathologist, Department of Plant Pathology, University of Kentucky, Lexington, KY

**Dr. Bob Houtz**, Chair, Department of Horticulture, University of Kentucky, Lexington, KY

**Nathan Howard**, Daviess County Extension Associate, Vegetable Crops, Owensboro, KY

**Nathan Howell**, Hart County Extension Associate, Vegetable Crops, Munfordville, KY

**Bob Karsner**, Horseshoe Bend Vineyard and Winery, Willisburg, KY

**Philip Konopka**, Lewis County Extension Agent for Agriculture and Natural Resources, Vanceburg, KY

**Bruce Kunze**, Grower, Utica, KY

**Lowell and Kathrine Land**, Acres of Land Winery, Richmond, KY

**Emmanuel de Lapparent**, General Manager of IFO-Fruit International, Havelock North, New Zealand

**Logan Leet**, Lovers Leap Winery, Lawrenceburg, KY

**Amy Poston Lentz**, Research Analyst, University of Kentucky, Lexington, KY

**Dr. Dave Lockwood**, Extension Fruit Specialist, Plant Sciences, University of Tennessee, Knoxville, TN

**Carson Merkwana**, River Bend Winery, Louisville, KY

**Mitch Lynd**, Retired, Lynd Fruit Farm, Pataskala, OH

**Lester Lynd**, President, Lynd Fruit Farm, Pataskala, OH

**Patti Meads**, Woodford County Extension Agent for Horticulture, Versailles, KY

**Dr. Diane Miller**, Fruit Specialist, Ohio State University, Wooster, OH

# WHO'S WHO

**Chris and Denise Nelson**, Chrisman Mill Vineyard, Nicholasville, KY

**Brandon O'Daniel**, Graduate Student, Department of Horticulture, University of Kentucky, Lexington, KY

**Dr. Kirk Pomper**, Principal Investigator of Horticulture, Curator, USDA-National Clonal Germplasm Repository for Pawpaw, Kentucky State University, Frankfort, KY

**Tom Priddy**, Meteorologist, Department of Biosystems and Agricultural Engineering, University of Kentucky, Lexington, KY

**Dr. Paul Read**, Professor, University of Nebraska-Lincoln, Agronomy & Horticulture, 377J PLSH, Lincoln NE 68583

**Nathan Rountt**, Business Development Specialist, Kentucky Center for Ag. and Rural Development (KCART), Department of Agricultural Economics, University of Kentucky, Lexington, KY

**Dr. Shubin Saha**, Regional Horticultural Specialist - Vegetable Specialist, Southwest Purdue Ag Center, Vincennes, IN

**Dr. Rebecca Schnelle**, Extension Floriculturist, Department of Horticulture, University of Kentucky, Lexington, KY

**Delia Scott**, Research Analyst, Department of Horticulture, University of Kentucky, Lexington, KY

**Dr. John Sedlacek**, Principal Investigator, Senior Research Entomologist, Kentucky State University, Frankfort, KY

**Dr. Kenny Seebold**, Extension Plant Pathologist, Department of Plant Pathology, University of Kentucky, Lexington, KY

**Chuck Smith**, Smith-Berry Vineyard & Winery, New Castle, KY

**Robbie Smith**, Nelson County Extension Agent for Horticulture, Bardstown, KY

**Bonnie Sigmon**, Laurel County Extension Agent for Horticulture, London, KY

**Darrell Slone**, UK Horticultural Research Farm Manager, Department of Horticulture, University of Kentucky, Lexington, KY

**Chris Smigell**, Small Fruit and Vegetable Extension Associate, University of Kentucky, Lexington, KY

**Dave Spalding**, Vegetable Extension Associate, Department of Horticulture, University of Kentucky, Lexington, KY

**Crystal Sparks**, Horticultural Technician, Department of Horticulture, University of Kentucky, Robinson Station, Jackson, KY

**Sharon Spencer**, Farmers' Market Marketing Specialist, Kentucky Department of Agriculture, Frankfort, KY

**Mac Stone**, Executive Director, Office of Marketing and Product Promotion, Kentucky Department of Agriculture, Frankfort, KY

**Robert Stone**, President Kentucky Vegetable Growers Association, Paris, KY

**Dr. John Strang**, Extension Fruit and Vegetable Specialist, Department of Horticulture, University of Kentucky, Lexington, KY

**Larry Swetnam**, Grower, Lexington, KY

**Roger Thomas**, Executive Director, Governors Office of Agricultural Policy, Frankfort, KY

**John Veigel**, Ball Seed Company, Eastern Kentucky and Southern West Virginia Representative, Nicholasville, KY

**Dr. Paul Vincelli**, Extension Plant Pathologist, Department of Plant Pathology, University of Kentucky, Lexington, KY

**Dennis and Bonnie Walter**, Chair Kentucky Grape & Wine Council, StoneBrook Winery, Camp Springs, KY

**Dick Wander**, Vice President, Lynd Fruit Farm, Pataskala, OH

**Adam Watson**, Fruit and Vegetable Marketing Specialist, Division of Value Added Plant Production, Kentucky Department of Agriculture, Frankfort, KY

**Jeff Wheeler**, Research Analyst, Department of Horticulture, University of Kentucky, Lexington, KY

**Jim Wight**, Wight-Meyer Vineyard & Winery, Shepherdsville, KY

**Dr. John Wilhoit**, Extension Specialty Crop Mechanization Specialist, Department of Biosystems and Agricultural Engineering, University of Kentucky, Lexington, KY

**Patsy Wilson**, Extension Viticulturist, Department of Horticulture, University of Kentucky, Lexington, KY

**Donniella Winchell**, Ohio Wine Producers Association, Austinburg, OH

**Dwight Wolfe**, Research Specialist, Department of Horticulture, University of Kentucky, Research and Education Center, Princeton, KY

**Dr. Tim Woods**, Agricultural Economics Extension Specialist, Department of Agricultural Economics, University of Kentucky, Lexington, KY

**Dr. Shawn Wright**, Horticulturist, Ohio State University South Centers, Piquette, OH

**Dr. Annette Wszelaki**, Commercial Vegetable Production Specialist, Plant Sciences Department, University of Tennessee, Knoxville, TN

# Exhibitors

All American Containers  
1111 Leader Rd., Geneva, NY 14456  
phone: 315-585-6045  
e-mail: rparmelee@allamericancontainers.com

Brick Packaging, LLC  
1732 Barlow Street, Traverse City, MI 49686  
phone: 231-947-4950  
e-mail: lindabrick@brickpackaging.com

Bunton Seed Company  
939 E. Jefferson St., Louisville, KY 40206  
phone: 502-584-0136  
e-mail: pam@buntonseed.com

Carolina Wine Supply  
5356 Old Plantation Circle  
Winston Salem, NC 27104  
phone: 336-677-6831  
e-mail: angie@carolinawinesupply.com

Clifton Seed Company  
P.O. Box 206, Faison, NC 28341  
phone: 910-267-2690  
e-mail: edr@cliftonseed.com

Continental Industries, Inc.  
P.O. Box 865, Shepherdsville, KY 40165  
phone: 502-543-2600  
e-mail: jchamilton@windstream.net

Criveller Company  
6935 Oakwood Dr., Niagara Falls, ON L2E655  
phone: 905-357-2930  
e-mail: info@criveller.com

Crop Production Services  
6803 North Henderson Ford Rd.  
Mooresville, IN 46158  
phone: 317-831-2559  
e-mail: john.phillips@uap.com

Deerfield Supplies  
2825 Stringtown Rd., Elkton, KY 42220  
phone: 270-265-2425

Earth Tools, Inc.  
1525 Kays Branch, Owenton, KY 40359  
phone: 502-484-3988

Governor's Office of Ag. Policy  
404 Ann Street, Frankfort, KY 40601  
phone: 502-564-4622  
e-mail: michael.judge@ky.gov

Green Hoe Co., Inc.  
6645 West Main, Portland, NY 14769  
phone: 716-792-9433  
e-mail: greenhoe@fairpoint.net

Hort Alliance Group  
226 Shady Lane, Midway, KY 40347  
phone: 859-229-3096  
e-mail: rmcniel@highlandmoor.com

Indiana Berry & Plant Co.  
2811 U.S. 31, Plymouth, IN 46563  
phone: 800-567-8264  
e-mail: dpalmer@indianaberry.com

Indiana Irrigation Co.  
12 Main Street, Onward, IN 46967  
phone: 574-626-3398  
e-mail: mark@indianairrigation.com

IR-4  
S-225L Agricultural Science Bldg. N  
Entomology Dept., University of Kentucky  
Lexington, KY 40546-0091  
phone: 859-257-7456  
e-mail: rbessin@uky.edu

Kentucky Department of Agriculture  
Division of Value Added Plant Production  
100 Fair Oaks Drive, 5th Floor  
Frankfort, KY 40601  
phone: 502-564-4983

Kentucky Irrigation Co. LLC  
340 Midland Place, Lexington, KY 40505  
phone: 859-254-7022  
e-mail: bob@kentuckyirrigation.com

Lincoln County Produce  
450 Al Wyler Rd., Crab Orchard, KY 40419  
phone: 606-355-0020

Miller Chemical Co.  
885 Baker Hill Rd., Cobden, IL 62920  
phone: 618-525-1818  
e-mail: rabbit\_grape@yahoo.com

New Crops Center  
N-318 Ag. Sci. Bldg. N, Dept. of  
Horticulture, University of Kentucky  
Lexington, KY 40546-0091  
phone: 859-257-1477  
e-mail: cgcass0@uky.edu

Organic Association of Kentucky  
2555 Mantews Lane, Lexington, KY 40511  
phone: 859-229-2232  
e-mail: larry@swetnam.net

Richey Equipment  
3213 Honeysuckle, White Pine, TN 37890  
phone: 865-674-6042  
fax: 865-674-7510  
e-mail: sales@richeyequipment.com

Rockford Package Supply  
10421 Northland Dr., Rockford, MI 49341  
phone: 616-866-0143  
e-mail: frontdesk@rockfordpack.com

Seedway, LLC  
7520 Ruggles Ferry Pike  
Knoxville, TN 37924  
phone: 865-548-7333  
e-mail: kbhosey@gmail.com

Spec Trellising Co.  
39 Indian Drive, P.O. Box 2204  
Ivyland, PA 18974  
phone: 1-800-237-4594  
e-mail: info@spectrellising.com

Thoroughbred Landscape Products  
4100 Heraldry Court, Lexington, KY 40513  
phone: 859-608-0846  
e-mail: johnthomptson@creechservices.com

USDA - Farm Service Agency  
771 Corporate Dr., Ste. 100  
Lexington, KY 40503  
phone: 859-224-7604  
e-mail: winnie.breeding@ky.usda.gov

Wabash Valley Progressive Viticulture,  
8902 S. 625 W, Rosedale, IN 457874  
phone: 765-548-6676  
JBDITZLER@email.com

Waters Agricultural Laboratories, Inc.  
2101 Old Calhoun Rd. - Hwy. 81  
Owensboro, KY 42301  
phone: 270-685-4039  
e-mail: jeff@watersag.com

## Literature Table

Krohne Plant Farms Inc.  
65295 County Road 342, Hartford, MI 49057  
phone: 269-424-5423  
e-mail: info@krohneplantfarms.com

Nourse Farms, Inc.  
41 River Road, South Deerfield, MA 01373  
phone: 413-665-2658

Putnam Plastics/Farm Products Div.  
255 South Alex Rd.  
West Carrollton, OH 45449  
phone: 800-457-3099  
e-mail: packaging@putnamfarm.com

2nd Floor

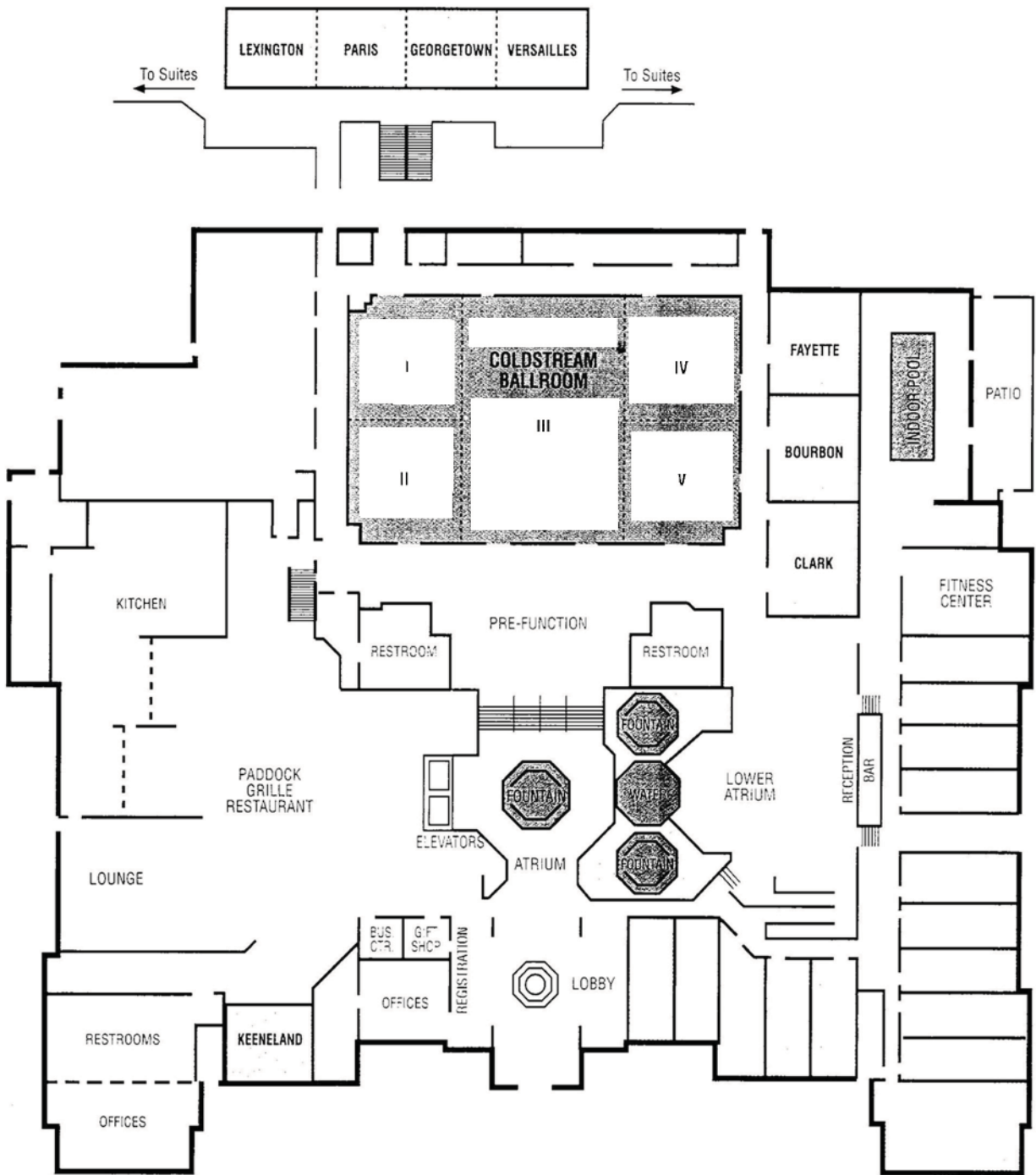

Kentucky State Horticultural Society  
UK Research & Education Center  
PO Box 469  
Princeton KY 42445-0469

## DIRECTIONS

From I-75/64: Take Exit 115 then right on to Newtown Pike. Turn right onto Aristides Blvd. at the UK Coldstream Research Campus. Hotel is on the right.  
From Blue Grass Airport: Exit left on to Man O'War Blvd. to Versailles Rd. Turn right onto Versailles Rd. Take Rt. 4 New Circle Rd. north to Newtown Pike Exit North. Turn left onto Aristides Blvd. at the UK Coldstream Research Campus. Hotel is on the right.

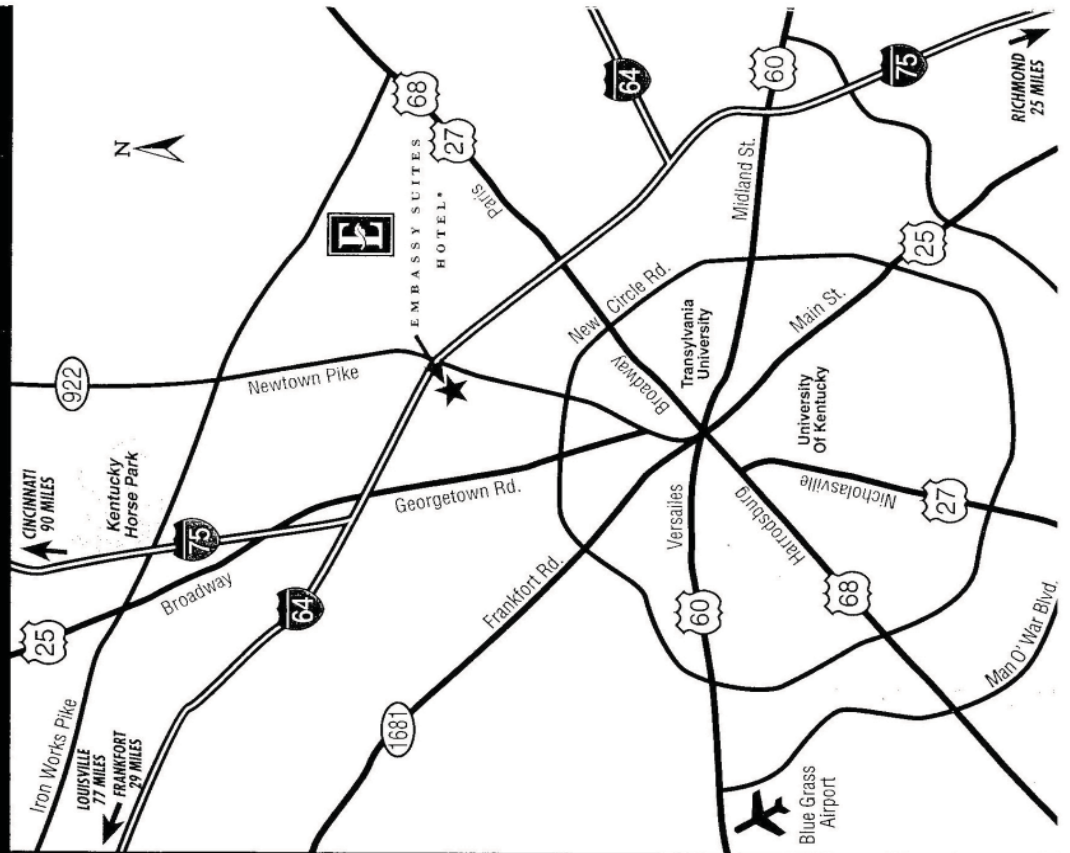

# KENTUCKY FRUIT AND VEGETABLE CONFERENCE

## Embassy Suites Hotel, Lexington KY -- January 4-5, 2010

Mark one: \_\_\_\_\_ ADVANCE REGISTRATION \_\_\_\_\_ I am not able to attend--continue my membership(s) as listed below.

NAME(S) for name tag (Please print) \_\_\_\_\_

ADDRESS \_\_\_\_\_

CITY, STATE \_\_\_\_\_ ZIP \_\_\_\_\_

PHONE: ( \_\_\_\_\_ ) \_\_\_\_\_ OCCUPATION/FIRM \_\_\_\_\_

FAX: ( \_\_\_\_\_ ) \_\_\_\_\_ E-Mail \_\_\_\_\_

\*\*\* PLEASE LIST NAME(S) OF ADDITIONAL REGISTRANTS: \_\_\_\_\_

I recommend \_\_\_\_\_ for the  KSHS or  KVGA Board of Directors.

Complimentary registration for County Extension Agents, University Students, and children under 15 years of age accompanying an adult.

**\*\* A \$30 registration allows entrance into any conference meeting session.**

One year membership plus meeting registration.

**\$30 PER PERSON**

Kentucky State Horticultural Society ----- Number attending \_\_\_\_\_

Kentucky Vegetable Growers Association ----- Number attending \_\_\_\_\_

Organic Association of Kentucky ----- Number attending \_\_\_\_\_

Meeting registration only (does not include organization membership.)

Mid West Apple Improvement Association---Number attending \_\_\_\_\_

Grape & Wine Short Course, Jan. 5 -----Number attending \_\_\_\_\_

\$30 each x Total number attending \_\_\_\_\_ = TOTAL \$ \_\_\_\_\_

KVS Membership Fee, + quarterly e-mail newsletter, \$25 each family (\$35 paper copy) TOTAL \$ \_\_\_\_\_

Register for the **Celebration of Kentucky Wines**, Jan. 4, 5:00-6:30 PM

Number attending \_\_\_\_\_ x \$10 each = TOTAL \$ \_\_\_\_\_

**EXHIBITOR/GROWER LUNCHEON -- January 4, 2010 / 12:00 Noon EST**

**\*\*Meal tickets are available only through advance registration.**

Number attending \_\_\_\_\_ x \$23 each = TOTAL \$ \_\_\_\_\_

**BANQUET - January 4, 2010 -- 6:30 p.m. EST**

**\*\*Meal prices include meal, tax and tips** Number attending \_\_\_\_\_ x \$35 each = TOTAL \$ \_\_\_\_\_

→ **Please make CHECKS payable to: KENTUCKY FRUIT AND VEGETABLE CONFERENCE**

CHECK # \_\_\_\_\_ CHECK AMT \$ \_\_\_\_\_ CASH AMT \$ \_\_\_\_\_ TOTAL PAID \$ \_\_\_\_\_

Mail advance registration to:

Mary Ann Kelley, Research & Education Center,  
PO Box 469, Princeton, KY 42445-0469  
Phone: 270-365-7541 x 216; Fax: 270-365-2667



Dr. John Strang, Coordinator

**ADVANCE REGISTRATION MUST BE RECEIVED BY MONDAY, DECEMBER 18, 2009**